

FT Drawbar Instructions



Simulated Coupler

There are two types of drawbars. One has a simulated coupler on the drawbar.

Part C

Part B

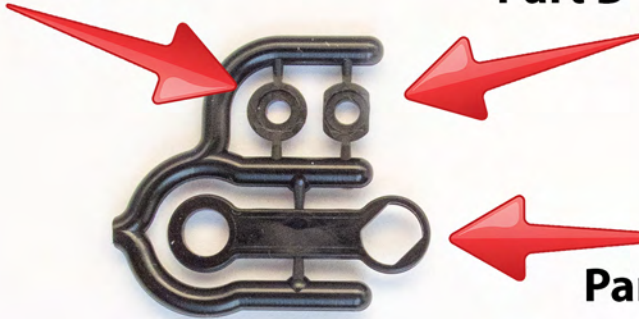

Part A



Part C



Flange

Place B unit in cradle. Place part B on post with flange facing up. Insert screw.

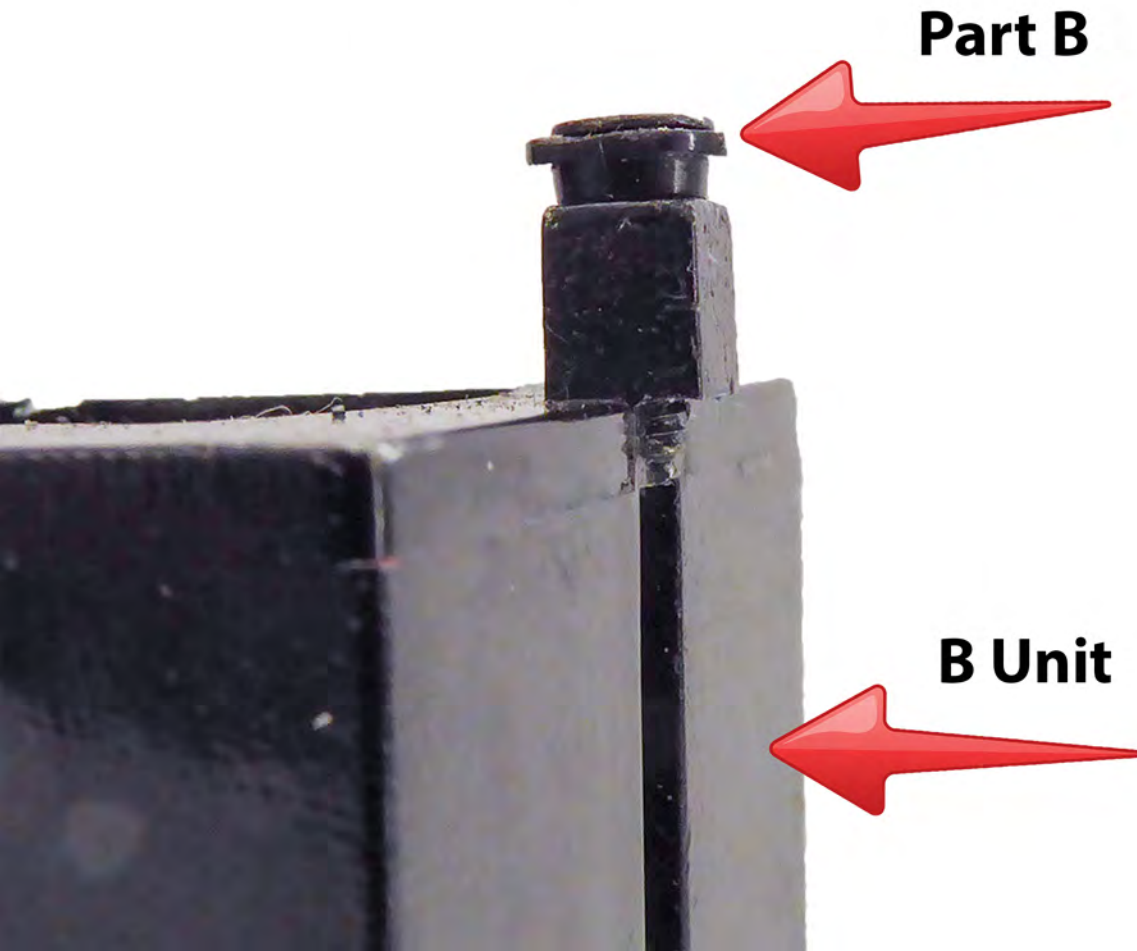

Place part C, with flange facing up into part A.

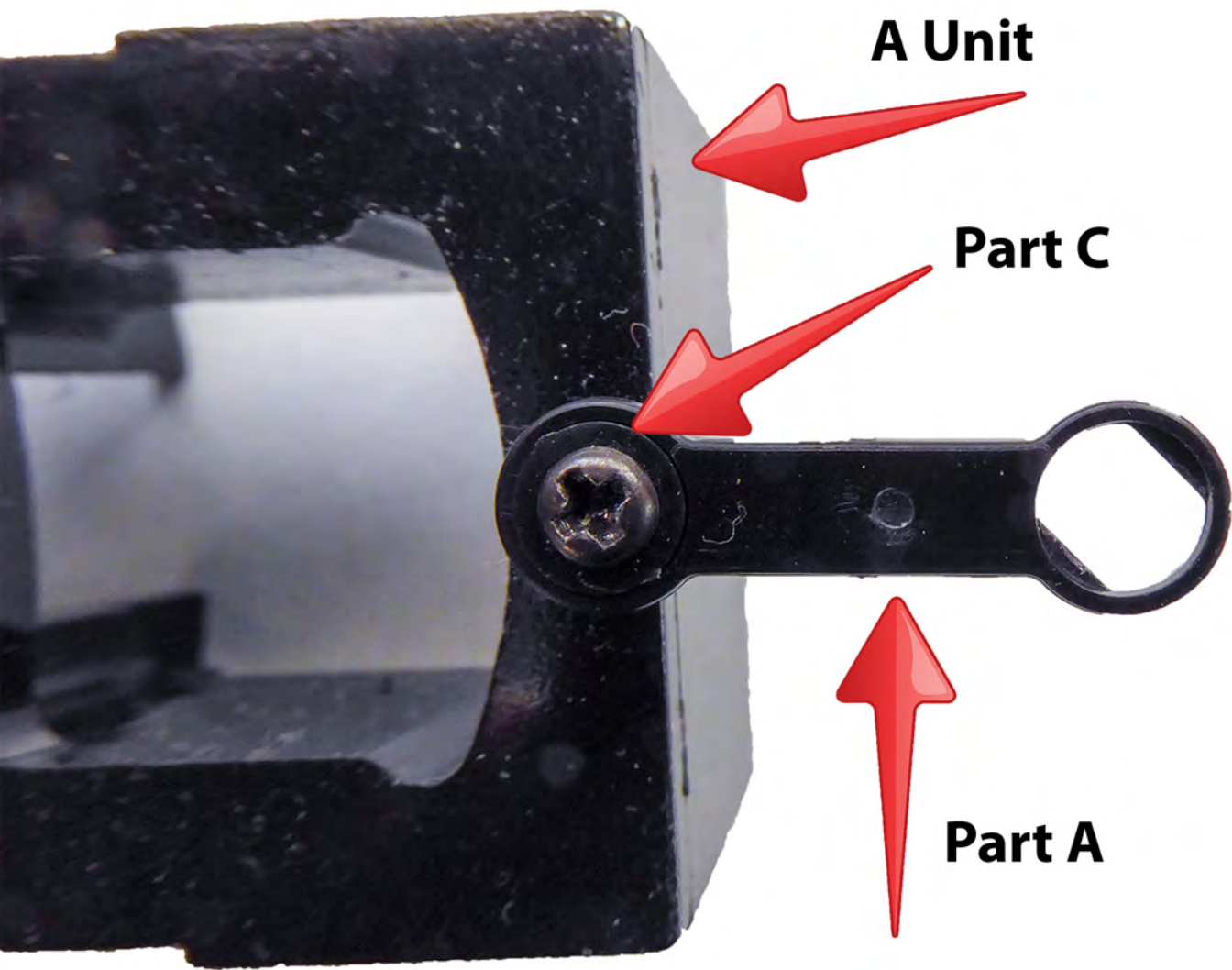

Part C



**Insert Part C into
Part A as shown.**



Part A

Attach Part A with Part C onto the A unit with the screw.



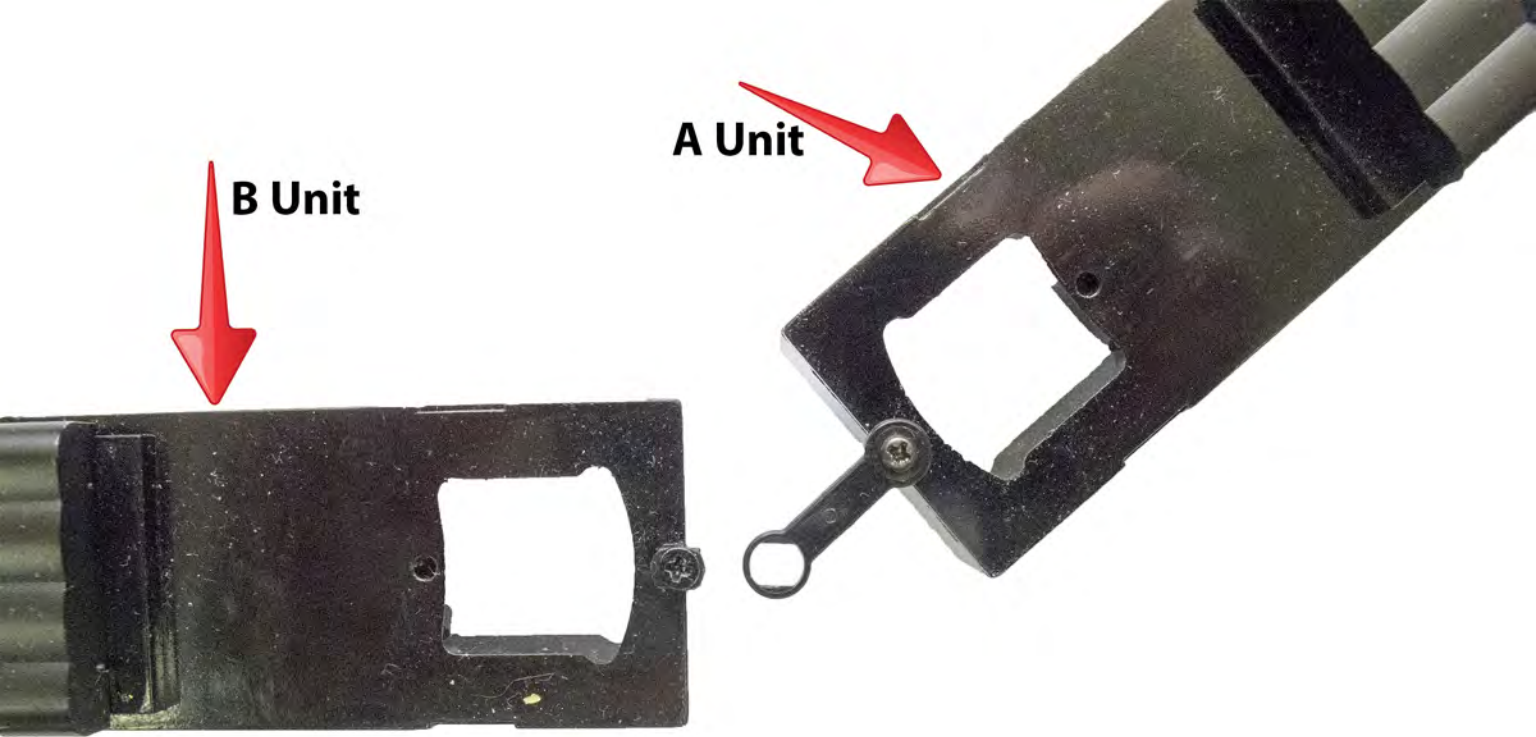

B Unit

A Unit

Arrange A and B units as shown.

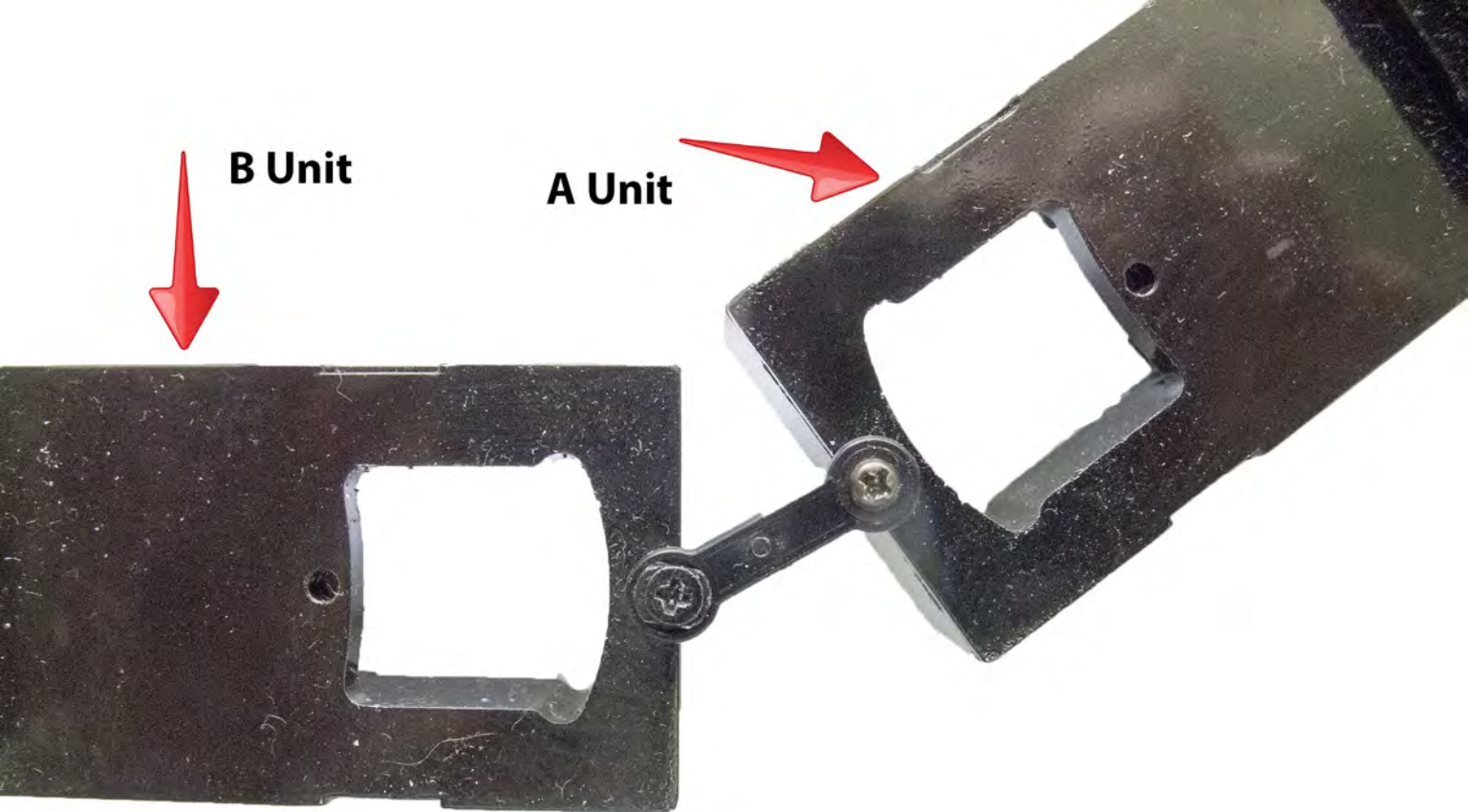

B Unit

A Unit

Attach A and B units as shown.

Straighten locomotives out and place on track.

